

MEFA mounting systems for Sprinkler

Approved products for water extinguishing systems

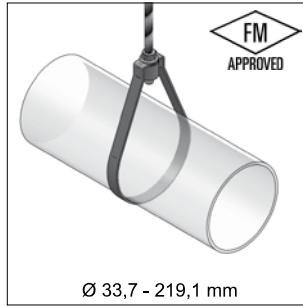

Sprinkler pipe loop "S"
Page 12/3



Sprinkler pipe loop "FM" SLH
Page 12/4

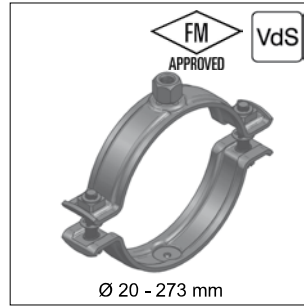

Sprinkler pipe clamp SPC
Page 12/5



Sprinkler pipe loop "R"
Page 12/7



U-bolt
See chapter 1

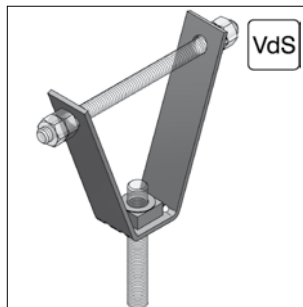

Trapeze hanger
See chapter 5

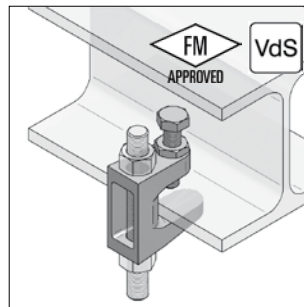

Girder clamps
See chapter 5

Pipe supports and components acc. to VdS CEA-guidelines for sprinkler systems VdS CEA 4001 "planning and installation"

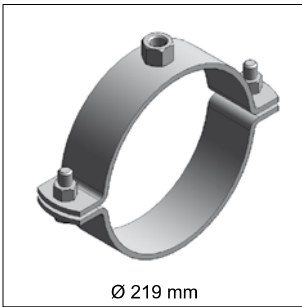

Sprinkler pipe clamp "SP"
Page 12/6



U-bolt
See chapter 1

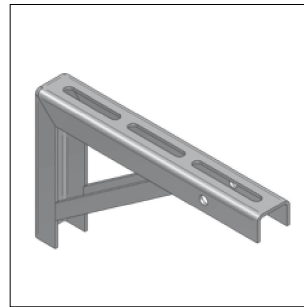

Consoles with brace
See chapter 2

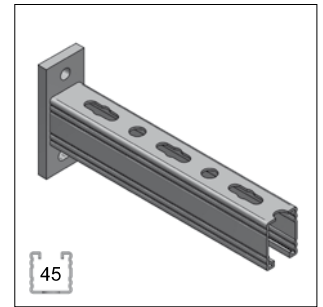

Consoles
Page 12/8

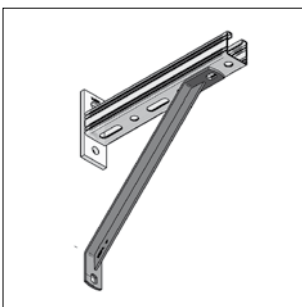

Brace 45° T-profile
See chapter 2

Tightening torque of locking screws on pipe clamps see chapter 15.

■ Assembly examples

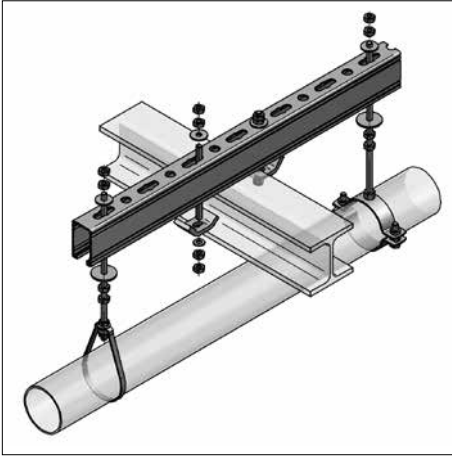

with steel girder

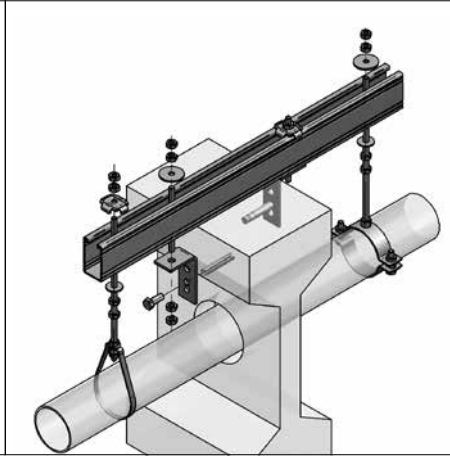

with reinforced concrete girder

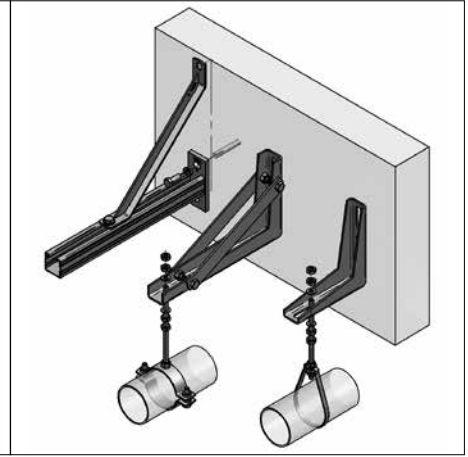

one-way projecting

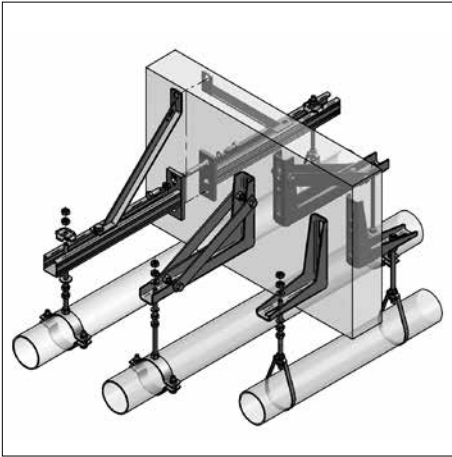

two-way projecting

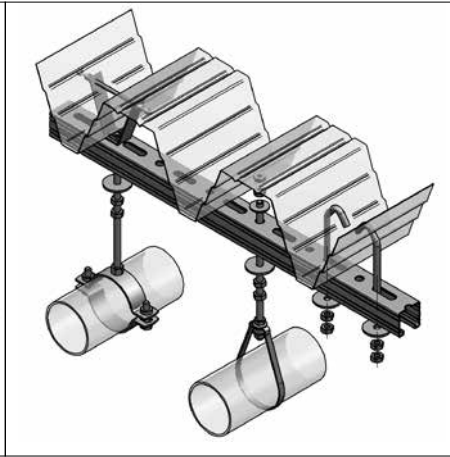

on trapeze sheet

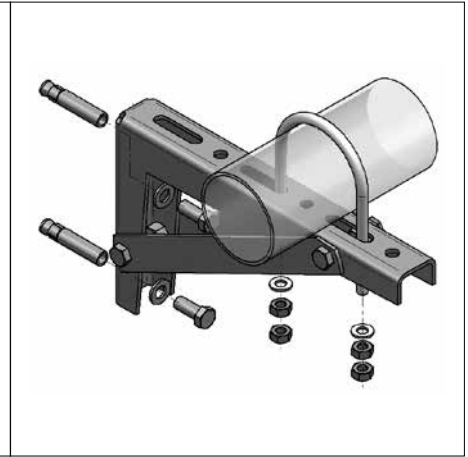

U-bolt on console

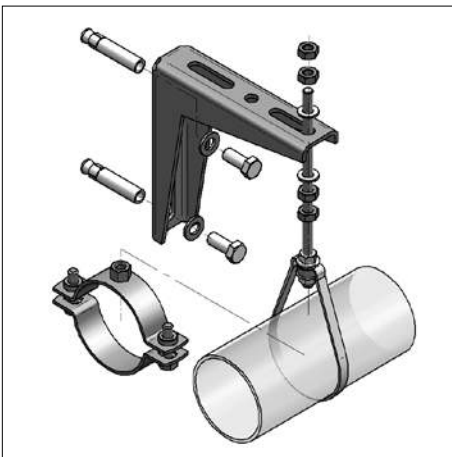

Universal console

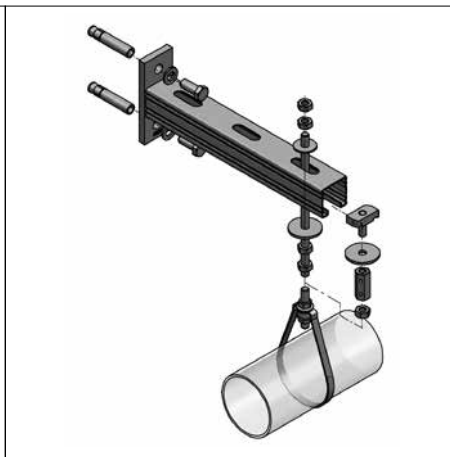

Console C-Profile

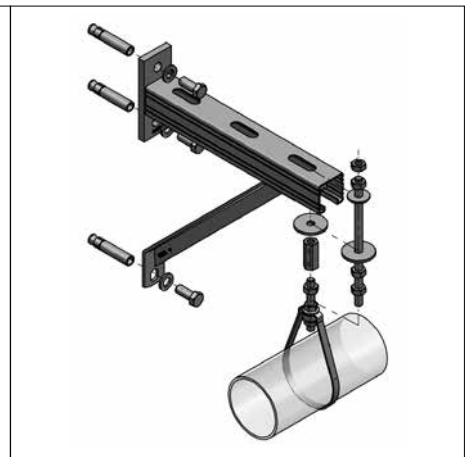

Console C-Profile with brace

12

■ Sprinkler pipe loop "S"



Sprinkler pipe loop „S“

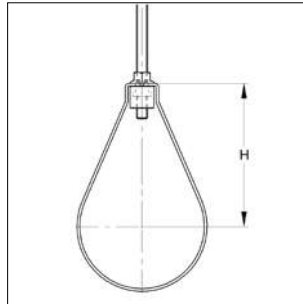

G 404 0051

Specification:

Application area:

- for stationary fire-protection in fixed water-extinguishing-systems
- sprinkler plant engineering
- deluge installation
- CO₂ extinguishing system
- halon fire extinguishing system
- foam extinguishing system
- powder fire extinguishing system

Technical data:

Material: steel
 Material type: S235JR
 Surface: galvanized

Delivery form: not mounted, flange nuts and cup nuts enclosed

Loads: according to VdS specifications

Construction according to VdS guidelines

Identification	Pipe [Inch]	max. load [kN]	Connection thread	Pipe- OD	H [mm]	Weight [kg/pc.]	Packing [pcs.]	Part-No.
Sprinkler pipe loop "S"	1	2,0	M8	33,7	57,0	0,060	100	470003401
Sprinkler pipe loop "S"	1 ^{1/4}	2,0	M8	42,4	57,0	0,062	50	470004201
Sprinkler pipe loop "S"	1 ^{1/2}	2,0	M8	48,3	62,0	0,065	50	470004801
Sprinkler pipe loop "S"	2	2,0	M8	60,3	71,0	0,071	50	470006001
Sprinkler pipe loop "S"	1	2,0	M10	33,7	57,0	0,080	100	470103401
Sprinkler pipe loop "S"	1 ^{1/4}	2,0	M10	42,4	57,0	0,081	50	470104201
Sprinkler pipe loop "S"	1 ^{1/2}	2,0	M10	48,3	62,0	0,085	50	470104801
Sprinkler pipe loop "S"	2	2,0	M10	60,3	71,0	0,091	50	470106001
Sprinkler pipe loop "S"	2 ^{1/2}	3,5	M10	76,1	87,5	0,119	25	470007601
Sprinkler pipe loop "S"	3	3,5	M10	88,9	102,5	0,129	25	470008901
Sprinkler pipe loop "S"	4	3,5	M10	114,3	132,5	0,150	25	470011401
Sprinkler pipe loop "S"	5	5,0	M12	139,7	147,0	0,233	25	470014001
Sprinkler pipe loop "S"	6	5,0	M12	168,3	175,0	0,262	25	470016501

 assembly instructions see chapter 15

 Single flang nuts see page 5/15

■ Sprinkler pipe loop "FM" SLH

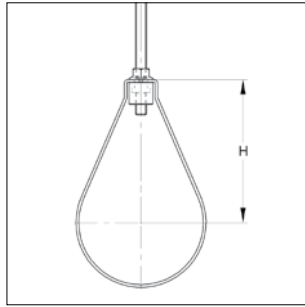

Sprinkler pipe loop „FM“

Specification:

- Application area:
- for stationary fire-protection in fixed water-extinguishing-systems
 - sprinkler plant engineering
 - deluge installation
 - CO₂ extinguishing system
 - halon fire extinguishing system
 - foam extinguishing system
 - powder fire extinguishing system

Brand: Eurofix Jiangmen

Delivery form: not mounted, flange nuts and cup nut enclosed

Loads: according to FM specifications

Technical data:

- Material: steel
 Material type: S235JR
 Surface: galvanized

Construction according to FM guidelines

Identification	Pipe [Inch]	max. load [kN]	Connection thread	Pipe-OD	H [mm]	Weight [kg/pc.]	Packing [pcs.]	Part-No.
Sprinkler pipe loop "FM" SLH	1	2,0	M10	33,7	55	0,077	100	47072034
Sprinkler pipe loop "FM" SLH	1 ^{1/4}	2,0	M10	42,4	55	0,079	100	47072042
Sprinkler pipe loop "FM" SLH	1 ^{1/2}	2,0	M10	48,3	60	0,082	50	47072048
Sprinkler pipe loop "FM" SLH	2	2,0	M10	60,3	69	0,087	50	47072060
Sprinkler pipe loop "FM" SLH	2 ^{1/2}	3,5	M10	76,1	85	0,147	50	47072076
Sprinkler pipe loop "FM" SLH	3	3,5	M10	88,9	100	0,162	25	47072089
Sprinkler pipe loop "FM" SLH	4	3,5	M10	114,3	130	0,191	25	47072114
Sprinkler pipe loop "FM" SLH	5	5,0	M12	139,7	145	0,247	20	47073140
Sprinkler pipe loop "FM" SLH	6	5,0	M12	168,3	173	0,278	20	47073168
Sprinkler pipe loop "FM" SLH	8	8,5	M16	219,1	220	0,608	10	47073219

i Single flang nuts see page 5/15

12

■ Sprinkler pipe clamp SPC

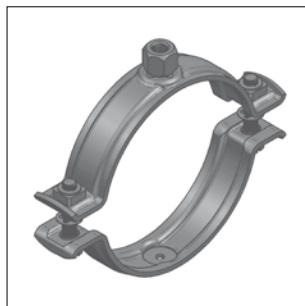

Sprinkler pipe clamp SPC

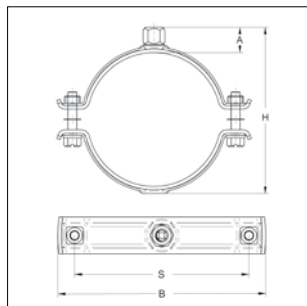

Specification:

Application area: for Sprinkler systems according to VdS and FM guidelines

Version: Pipe clamp with connection thread according to sprinkler guidelines.
Locking screws are secured by a plastic washer.

Technical data:

Material: steel
Surface: galvanized

* Correspond guidelines for Sprinkler systems "VdS CEA 4001 planning and installation"

Connection: Thread M8

clamping range	Classification	Material	Closure-	max. load	H	A	B	s	Weight	Packing	Part-No.
[mm]	[Inch]	[mm]	screws	[kN]	[mm]	[mm]	[mm]	[mm]	[kg/pc.]	[pcs.]	
20-24	1/2"	VdS 30x2,5	M8	2,5	42	15	66	44	0,141	50	47300020
25-30	3/4"	VdS 30x2,5	M8	2,5	50	17	71	50	0,148	50	47300025
31-35	1"	VdS 30x2,5	M8	2,5	55	16	77	55	0,155	50	47300031
40-45	1 1/4"	VdS 30x2,5	M8	2,5	65	16	88	66	0,174	50	47300040
48-53	1 1/2"	VdS 30x2,5	M8	2,5	73	16	96	74	0,192	50	47300048
60-65	2"	VdS 30x2,5	M8	2,5	85	16	108	87	0,217	50	47300061

Connection: Thread M10

20-24	1/2"	VdS 30x2,5	M8	2,5	44	17	66	44	0,141	50	47300022
25-30	3/4"	VdS/FM 30x2,5	M8	2,5	52	19	71	50	0,148	50	47300027
31-35	1"	VdS/FM 30x2,5	M8	2,5	57	18	77	55	0,155	50	47300034
40-45	1 1/4"	VdS/FM 30x2,5	M8	2,5	67	18	88	66	0,174	50	47300043
48-53	1 1/2"	VdS/FM 30x2,5	M8	2,5	75	18	96	74	0,192	50	47300050
60-65	2"	VdS/FM 30x2,5	M8	2,5	87	18	108	87	0,217	50	47300060
76-81	2 1/2"	VdS/FM 30x3,0	M8	3,5	105	20	135	108	0,292	25	47300076
88-93	3"	VdS/FM 30x3,0	M8	3,5	117	20	147	120	0,319	25	47300088
110-116	4"	FM* 30x3,0	M8	3,5	140	20	171	144	0,365	25	47300110

Connection: Thread M12

140-148	5"	VdS/FM 40x4,0	M12	5,0	168	19	216	186	0,806	10	47300140
167-173	6"	FM* 40x4,0	M12	5,0	193	19	242	212	0,903	10	47300167

■ Sprinkler pipe clamp "SP"

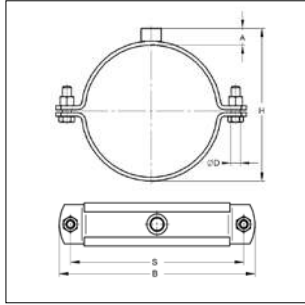

Sprinkler pipe clamp "SP"

max. load according to VdS

nominal width of pipe	cross section	max. load
≤ DN 50	75 mm ²	2,0 kN
> DN 50 ≤ DN 100	90 mm ²	3,5 kN
> DN 100 ≤ DN 150	90 mm ²	5,0 kN
> DN 150 ≤ DN 200	250 mm ²	8,5 kN
> DN 200 ≤ DN 250	250 mm ²	10,0 kN

Specification:

- Application area:
- for Sprinkler systems (choice and application according to VdS guidelines for Sprinkler systems VdS CEA 4001, planning and installation)
- Version:
- connection thread from dimension 50x5 circular welded
 - for double mounting thru flange holes on request

Technical data:

- Material: steel
 Material type: S235JR
 Surface: galvanized



Meeting VdS guidelines for Sprinkler systems VdS CEA 4001, planning and installation

* similar closure screws as Titan HD clamp (see chapter 1)

Connection: Thread M16 DN > 150 ≤ 200

Type "SP"	219 *	8	50x5,0	M12	249	25	297	268	1,724	1	0477219
-----------	-------	---	--------	-----	-----	----	-----	-----	-------	---	---------

Connection: Thread M20 DN > 200 ≤ 250

Type "SP"	273 *	10	50x5,0	M12	300	22	351	322	2,100	1	0478273
-----------	-------	----	--------	-----	-----	----	-----	-----	-------	---	---------

■ Sprinkler pipe loop "R"

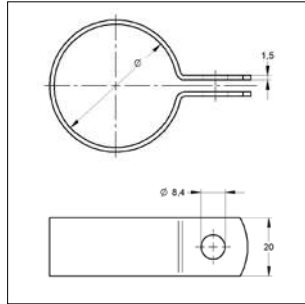
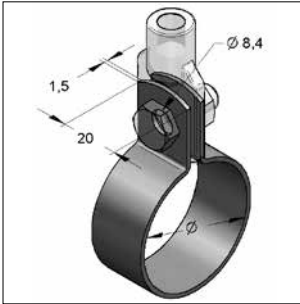

G 494 0028

Sprinkler pipe loop "R"

Specification:

- Application area:
- one-part
 - pipe clamps without closure-screws
 - sprinkler pipe loop "R" may be mounted only in connection with adapter-mounting eye
- Needed accessory:
- required closure-screws M8 according to DIN EN ISO 4017
 - nuts according to DIN EN ISO 4032

Technical data:

- Material: steel
 Material type: S235JR
 Surface: galvanized

Identification	Pipe [Inch]	Pipe-OD	Weight [kg/pc.]	Packing [pc.]	Part-No
Sprinkler pipe loop "R"	1/2	21,3	0,024	1	0340014
Sprinkler pipe loop "R"	3/4	26,9	0,028	1	0340022
Sprinkler pipe loop "R"	1	33,7	0,033	1	0340030

■ Eye adaptor

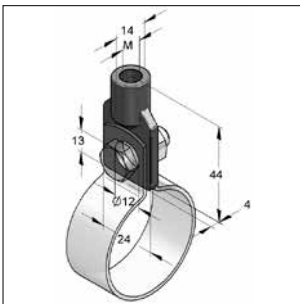

Eye adaptor

Specification:

- Application area:
- for sprinkler pipe loop "R"
- Needed accessory:
- required closure-screws M8 according to DIN EN ISO 4017,
 - nuts according to DIN EN ISO 4032

Technical data:

- Material: malleable cast iron
 Surface: galvanized

Identification	female-thread [M]	max. load according to VdS [kN]	Weight [kg/pc.]	Packing [pcs.]	Part-No.
Eye adaptor BO 25-8	M8	2,0	0,028	50	0350152
Eye adaptor BO 25-10	M10	3,5	0,025	50	0350174

■ Console C-profile 45/45/2,5 mm

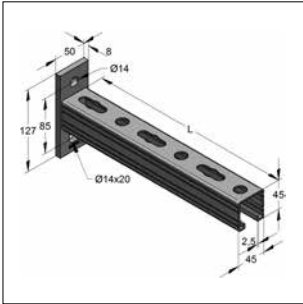

Sprinkler- Console 45/45//2,5
lengthwise

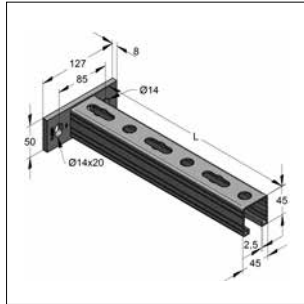

Sprinkler- Console 45/45//2,5
crosswise

Technical data: galvanized

Material type plate:	S355J2, $f_y = 355 \text{ N/mm}^2$	dimensions plate:	127 x 50 x 8,0 mm
Material type profile rails:	S235JR, $f_y = 235 \text{ N/mm}^2$	dimensions profile rails:	45 x 45 x 2,5 mm
Surface:	galvanized		
Material:	steel		
global safety coefficient	1,54		

* on request

Console 45/45//2,5 lengthwise

Identification	Length L [mm]	max. load			Weight [kg/pc.]	Packing [pcs.]	Part-No
		load situation 1 F1 [kN]	load situation 2 F2 [kN]	load situation 3 q0 [kN/m]			
Console 45/45/2,5	210*	4,98	2,49	23,70	0,99	1	9992222
Console 45/45/2,5	315	3,32	1,66	10,53	1,30	15	9992306
Console 45/45/2,5	420	2,49	1,24	5,92	1,61	10	9992307
Console 45/45/2,5	525	1,99	1,00	3,79	1,92	10	9992308
Console 45/45/2,5	630	1,66	0,83	2,63	2,24	5	9992309
Console 45/45/2,5	735	1,42	0,68	1,93	2,55	5	9992310

Console 45/45//2,5 crosswise

Console 45/45/2,5	210*	3,68	1,84	17,52	0,99	1	9992218
Console 45/45/2,5	315	2,45	1,23	7,78	1,30	15	9992219
Console 45/45/2,5	420	1,84	0,92	4,38	1,61	10	9992220
Console 45/45/2,5	525*	1,48	0,74	2,80	1,92	10	9992221

load situation 1

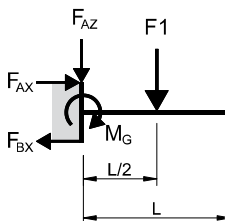

$F_{AZ} = F1$	$M_G = \frac{F1 * L}{2}$
---------------	--------------------------

load situation 2

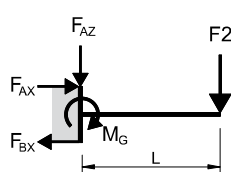

$F_{AZ} = F2$	$M_G = F2 * L$
---------------	----------------

load situation 3

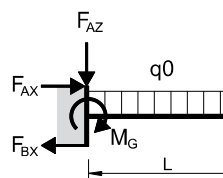

$F_{AZ} = q0 * L$	$M_G = \frac{q0 * L^2}{2}$
-------------------	----------------------------

Notice:

All load capacities excessive refer to static loads